

# Hurricane<sup>®</sup>

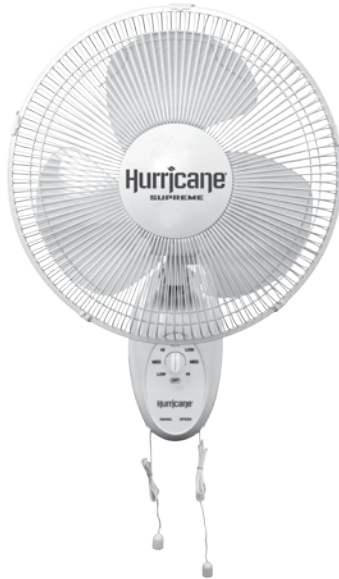

## 12" OSCILLATING WALL MOUNT FAN INSTRUCTIONS



**CAUTION: Read Rules for Safe Operation and Instructions Carefully.**

### WARNING

1. This appliance has a polarized plug (one blade is wider than the other). To reduce the risk of electric shock, this plug is intended to fit in a polarized outlet only one way. If plug does not fit fully in the outlet, reverse the plug. If it still does not fit, contact a qualified electrician. **DO NOT** attempt to defeat this safety feature.
2. To reduce the risk of fire or electric shock, **DO NOT** use fan with any solid-state speed control devices.

### RULES FOR SAFE OPERATION

1. Never insert fingers, pencils, or any other object through the grill when fan is running.
2. Disconnect fan when moving from one location to another.
3. Disconnect fan when removing grills for cleaning.
4. Be sure fan is on a stable surface when operating to avoid overturning.
5. **DO NOT** use fan in window. Rain may create electrical hazard.
6. Ensure that the fan is switched off from the supply mains before removing the grill.



## The rules about the cord and plug.

1. This product employs overload protection (fuse). A blown fuse indicates an overload or short-circuit situation. If the fuse blows, unplug the product from the outlet. Replace the fuse as per the user servicing instructions (follow product marking for proper fuse rating) and check the products. If the replacement fuse blows, a short-circuit may be present and the product should be discarded or returned to an authorized service facility for examination and/or repair.
2. Do not operate any fan with a damaged cord or plug. Discard fan or return to an authorized service facility for examination and/or repair.
3. Do not run cord under carpeting. Do not cover cord with throw rugs, runners, or similar coverings. Do not route cord under furniture or appliances. Arrange cord away from traffic area and where it will not be tripped over.

## FAN SETUP

1. Determine desired location of fan. Mount fan at least 5 feet above floor.
2. Mark 2 screw holes with a pencil by holding hanging bracket to wall.
3. Drill starter holes at 2 pencil marks.
4. Insert anchors (not included) into each hole & lightly tap them flush to wall with a hammer.
5. Secure hanging bracket with two (2) provided screws.
6. Hang fan onto wall by inserting built-in female bracket on fan base into hanging bracket.

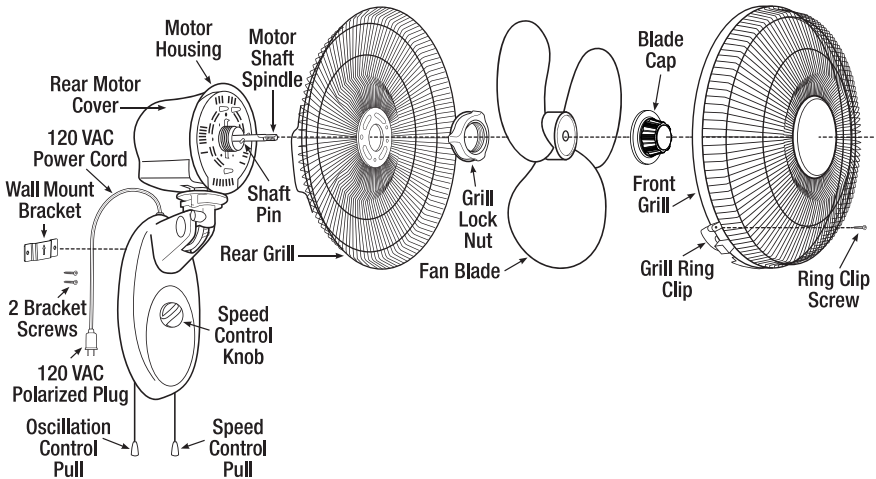

## FAN OPERATION

1. Plug power cord into a standard 120 volt AC wall outlet.
2. To turn fan on, gently pull on chain to select your desired speed. One pull turns fan on Low, two pulls for Medium and three pulls for High. The fourth pull will turn fan Off.
3. TILTING: Always switch off fan before making adjustments. Holding rear motor cover, tilt fan head either up or down.
4. OSCILLATION: Pull cord down to make fan oscillate. Pull cord again to stop oscillation.

## Follow these safety precautions carefully.

1. Use fan only as directed in these instructions. Failure to do so may cause fire electrical shock or injury.
2. Intended for household use, not commercial or industrial.
3. DO NOT immerse unit, plug or cord in water or spray with liquids.
4. DO NOT leave children unsupervised around any appliance.
5. Unplug fan from outlet when not in use, when moving fan or before cleaning.
6. Avoid contact with moving parts.
7. DO NOT operate in the presence of explosive and/or flammable fumes.
8. DO NOT place fan or any parts near an open flame, cooking or other heating appliance.
9. DO NOT operate fan with a damaged cord, plug, after the fan malfunctions or after the fan has been dropped/damaged in any manner.
10. DO NOT use outdoors.
11. DO NOT let cord hang over the edge of a table/counter or let it touch hot surfaces.
12. To disconnect, grip plug and pull from wall outlet. NEVER YANK ON CORD.
13. Always use on a dry level surface.
14. DO NOT hang or mount fan on ceiling.
15. DO NOT operate without fan grills properly in place.
16. To reduce risk of shock, polarized plug is intended to fit in a polarized outlet only one way. (One blade is wider than the other). If plug does not fit in the outlet, reverse plug. If it still does not fit, contact a qualified electrician. DO NOT defeat the purpose of this safety feature.

## Save these important safety instructions.

### WARNING:

To reduce the risk of fire, electrical shock and/or injury to persons- DO NOT use in a window.

### WARNING:

DO NOT use this fan with any solid state speed control device.

## Fan must be mounted on a vertical wall.



**Do not mount  
on a ceiling.**



**Do not mount  
on an incline.**



**Do not mount  
on an angle.**

- Place the fan base flush to the hanging bracket.
- Make sure the power cord



## CARE & STORAGE

1. BE SURE THE PLUG IS REMOVED FROM OUTLET before attempting any cleaning or maintenance.
2. Use only a soft, moist cloth with a soap solution.
3. DO NOT immerse the fan in water, and never allow water to drip into the motor housing.
4. DO NOT use a gasoline thinner or other chemicals to clean fan.
5. To dismantle for cleaning or long-term storage: Follow assembly instructions in reverse order. The fan blade may be washed in warm water using a little mild detergent. Alternatively it may be wiped clean with a soft damp cloth. Be sure it is completely dry before re-fitting.
6. The front and rear guards can be cleaned with a soft brush or soft damp cloth.
7. The motor housing and pedestal can be wiped clean with a soft damp cloth.
8. For storage, clean fan carefully as instructed and store in it's original box. Store fan in a clean, dry place.

## USER SERVICING INSTRUCTIONS (UL)

1. Grasp plug and remove from the receptacle or other outlet device. DO NOT unplug by pulling on cord.
2. Open fuse cover. Slide open fuse access cover on top of attachment plug towards blades.
3. Remove fuse carefully. Insert the tip of your tool into fuse slot (close with the terminal), then pry the fuse gradually and slowly, but not overexert. If fuse feels tight, you can try again to carefully pry it out little by little. After one side of the fuse has been pried out, you can remove the fuse entirely.
4. Risk of fire. Replace fuse only with 2.5 Amp, 125 Volt fuse.
5. Close fuse cover. Slide the fuse access cover on top of the plug until it is closed.
6. Risk of fire. DO NOT replace attachment plug. Contains a safety device (fuse) that should not be removed. Discard product if the attachment plug is damaged.

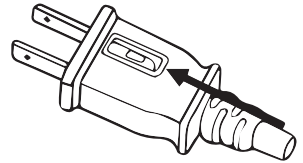

### Note:

1. When you replace the fuse, please don't operate suddenly or overexert, or else the product may become damaged or cause accident.
2. If the plug does not go into the outlet easily, please make sure you have the plug turned the right way.

# #736500

**Hurricane**<sup>®</sup>  
www.hurricane-fans.com



Exclusively distributed by:

**Sunlight Supply, Inc.**

SunlightSupply.com